



PACKAGING

A complete line of reinforcement and opening products for corrugated and folding carton packaging.



Create better functioning boxes, bins and trays with our hot melt coated tapes and strings. Our products are available in various tensile strengths and melt points. An H.B. Fuller technical representative can help you determine the optimum product for your specific application.

REINFORCEMENT AND CONTAINMENT PRODUCTS

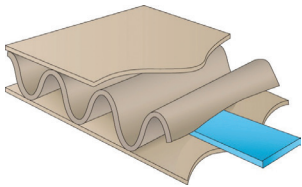

SESAME® TAPE

- Applied inside the board
- Used for reinforcement and containment
- Available in multiple widths

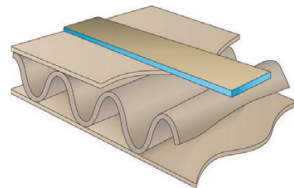

SESAME® KRAFT BACKED TAPE

- Applied on top of the inside liner
- Wide tape used for reinforcement and containment (5/16" or 7mm or wider)
- Available in a variety of widths

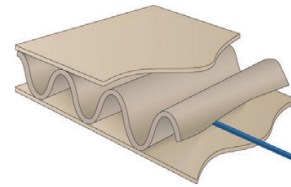

SESAME® STRING

- Applied inside the board
- Used for score line reinforcement and containment

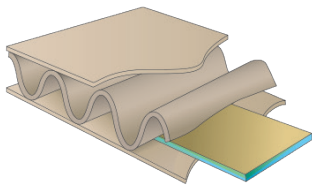

SESAME® SPECIALIZED REINFORCEMENT TAPE

- Applied inside the board
- Wide tape is used for specialized reinforcement in large boxes

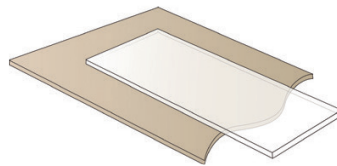

ENFORCER™ TAPE

- Applied on folding carton
- Used for beverage handle reinforcement
- Applied on high speed intermittent applicator

OPENING PRODUCTS

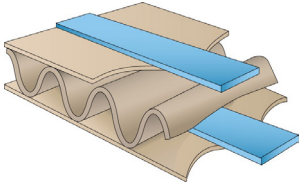

OPEN-SESAME® 2 TAPE SYSTEM

- Open-Sesame tape is applied on top of liner; a Sesame tape is used as a guide tape and applied inside the board
- Used for premium clean tear
- Available in variety of widths

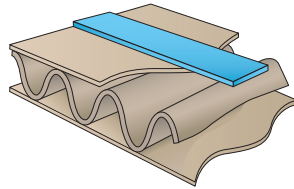

OPEN-SESAME 1 TAPE SYSTEM

- Applied on top of liner
- Used for clean tear
- Available in variety of widths

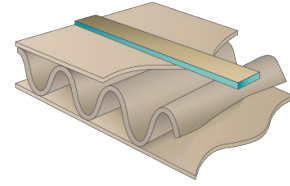

SESAME KRAFT BACKED TAPE NARROW

- Applied on top of liner
- Narrow tape used to create clean tear or for access to contents

FILM TAPE PRODUCTS

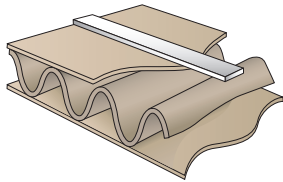

SESAME® FILM TAPE

- Applied on top of board
- In line application
- Narrow tear tape opening to access contents

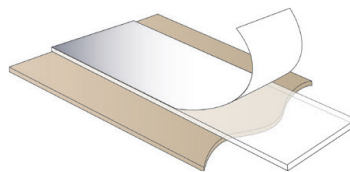

CLOSE-SESAME™ TAPE

- Applied on top of board
- In line application
- Provide aggressive bond to ensure closure

ABOUT H.B. FULLER

Since 1887, H.B. Fuller has been a leading global adhesives provider focusing on perfecting adhesives, sealants and other specialty chemical products to improve products and lives. With fiscal 2018 net revenue of over \$3 billion, H.B. Fuller's commitment to innovation brings together people, products and processes that answer and solve some of the world's biggest challenges. Our reliable, responsive service creates lasting, rewarding connections with customers in electronics, disposable hygiene, medical, transportation, aerospace, clean energy, packaging, construction, woodworking, general industries and other consumer businesses. And, our promise to our people connects them with opportunities to innovate and thrive. For more information, visit us at hbfuller.com.



For more information about our company, visit www.hbfuller.com.

 Join the Conversation | www.hbfuller.com/connect

IMPORTANT: The information contained herein is believed to be correct to the best of our knowledge. However the recommendations and suggestions herein are made without guarantee or representation as to results. It is the purchaser's responsibility to test and determine the suitability of the product for the purchaser's intended use and purpose. Purchaser assumes all risk and liability whatsoever regarding such suitability. Any product samples provided for testing are provided in accordance with standard limited warranties as stated on our technical data sheets.

Sesame®, Enforcer™, Open-Sesame, Cutting-Edge and Close-Sesame are trademarks of H.B. Fuller and are registered in the U.S. and other countries.

© H.B. Fuller Company, 2019. 0100 – Rev. 05/2019